

# CODOLI MAS 403 BT

## PULL STUDS MAS 403 BT



**SENZA FORO**  
*WITHOUT BORE*



**FORATO**  
*WITH BORE*



**CON DOPPIO OR**  
*WITH DOUBLE O-RING*



**PROLUNGATO**  
*EXTENDED FOR MT SLEEVES*

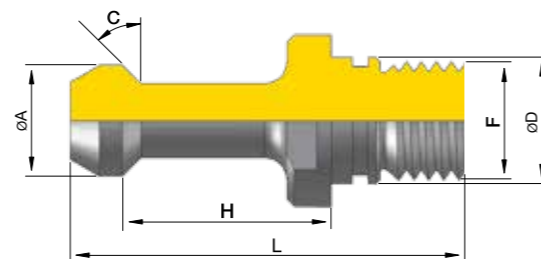
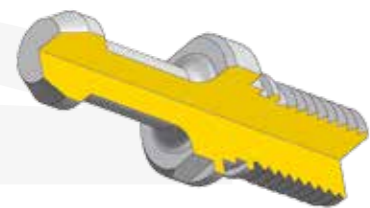

**MAS 403 - SENZA FORO - WITHOUT COOLANT BORE**

**SENZA FORO**

Cod.	F	C	ØD	ØA	H	L	TOOL SHANK	NOTE
PS.BT30.1	M12	45°	12,5	11	18	43	BT30	Without oring
PS.BT30.2	M12	60°	12,5	11	18	43	BT30	Without oring
PS.BT30.3	M12	90°	12,5	11	18	43	BT30	Without oring
PS.BT40.1	M16	45°	17	15	28	60	BT40	-

Cod.	F	C	ØD	ØA	H	L	TOOL SHANK	NOTE
PS.BT40.2	M16	60°	17	15	28	60	BT40	-
PS.BT40.3	M16	90°	17	15	28	60	BT40	-
PS.BT50.1	M24	45°	25	23	35	85	BT50	-
PS.BT50.2	M24	60°	25	23	35	85	BT50	-
PS.BT50.3	M24	90°	25	23	35	85	BT50	-

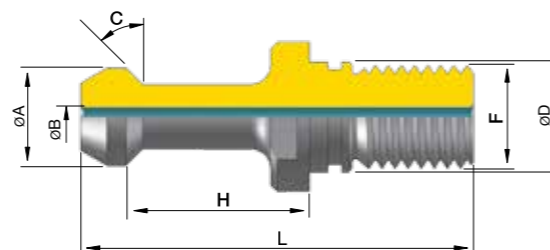
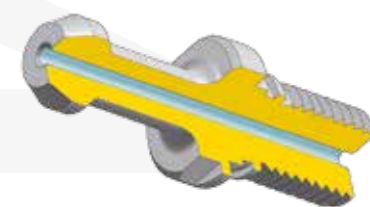

**MAS 403 - FORATI - WITH COOLANT BORE**

**FORATO**

Cod.	F	C	ØD	ØA	H	L	ØB	TOOL SHANK	NOTE
PS.BT30.1F	M12	45°	12,5	11	18	43	2,5	BT30	Without oring
PS.BT30.2F	M12	60°	12,5	11	18	43	2,5	BT30	Without oring
PS.BT30.3F	M12	90°	12,5	11	18	43	2,5	BT30	Without oring
PS.BT40.1F	M16	45°	17	15	28	60	3	BT40	-

Cod.	F	C	ØD	ØA	H	L	ØB	TOOL SHANK	NOTE
PS.BT40.2F	M16	60°	17	15	28	60	3	BT40	-
PS.BT40.3F	M16	90°	17	15	28	60	3	BT40	-
PS.BT50.1F	M24	45°	25	23	35	85	6	BT50	-
PS.BT50.2F	M24	60°	25	23	35	85	6	BT50	-
PS.BT50.3F	M24	90°	25	23	35	85	6	BT50	-

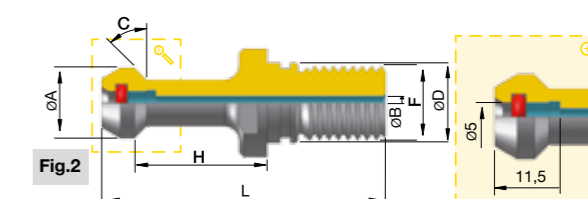
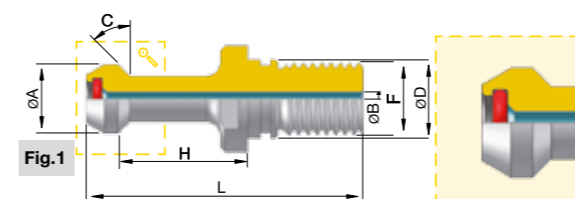

**CODOLI CON DOPPIO O-RING PER REFRIGERANTE AD ALTA PRESSIONE  
SEALED PULL STUDS WITH DOUBLE O-RING FOR HIGH PRESSURE COOLANT**

**CON DOPPIO OR**

Cod.	F	C	ØD	ØA	H	L	ØB	TOOL SHANK	NOTE
PS.BT40.1F20R	M16	45°	17	15	28	60	3	BT40	Fig.1
PS.BT40.1F20R5	M16	45°	17	15	28	60	3	BT40	Fig.2
PS.BT40.2F20R	M16	60°	17	15	28	60	3	BT40	Fig.1

Cod.	F	C	ØD	ØA	H	L	ØB	TOOL SHANK	NOTE
PS.BT50.1F20R	M24	45°	25	23	35	85	6	BT50	Fig.1
PS.BT50.2F20R	M24	60°	25	23	35	85	6	BT50	Fig.1
PS.BT50.3F20R	M24	90°	25	23	35	85	6	BT50	Fig.1

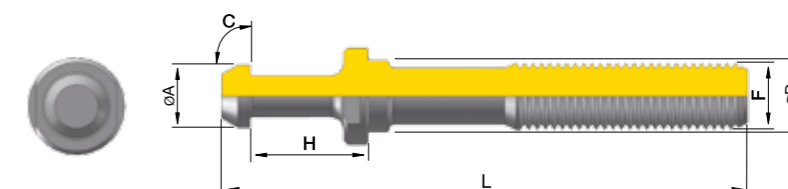
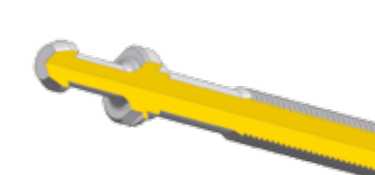

**MAS 403 BT - PROLUNGATI - EXTENDED FOR MT SLEEVES**

**PROLUNGATO**

Cod.	F	C	ØD	ØA	H	L	TOOL SHANK	MORSE TAPER
PS.BT.PR.M10.1	M10	45°	17	15	28	120	BT40	2
PS.BT.PR.M12.1	M12	45°	17	15	28	120	BT40	3
PS.BT.PR.M16.1	M16	45°	17	15	28	125	BT40	4
PS.BT.PR.M10.2	M10	60°	17	15	28	120	BT40	2
PS.BT.PR.M12.2	M12	60°	17	15	28	120	BT40	3

Cod.	F	C	ØD	ØA	H	L	TOOL SHANK	MORSE TAPER
PS.BT.PR.M16.2	M16	60°	17	15	28	125	BT40	4
PS.BT.PR.M10.3	M10	90°	17	15	28	120	BT40	2
PS.BT.PR.M12.3	M12	90°	17	15	28	120	BT40	3
PS.BT.PR.M16.3	M16	90°	17	15	28	125	BT40	4